



# Kline Tower (KT) Renovation

## Town Hall Meeting

February 19, 2020



# Project Site Logistics: Pedestrian Access to CSSSI

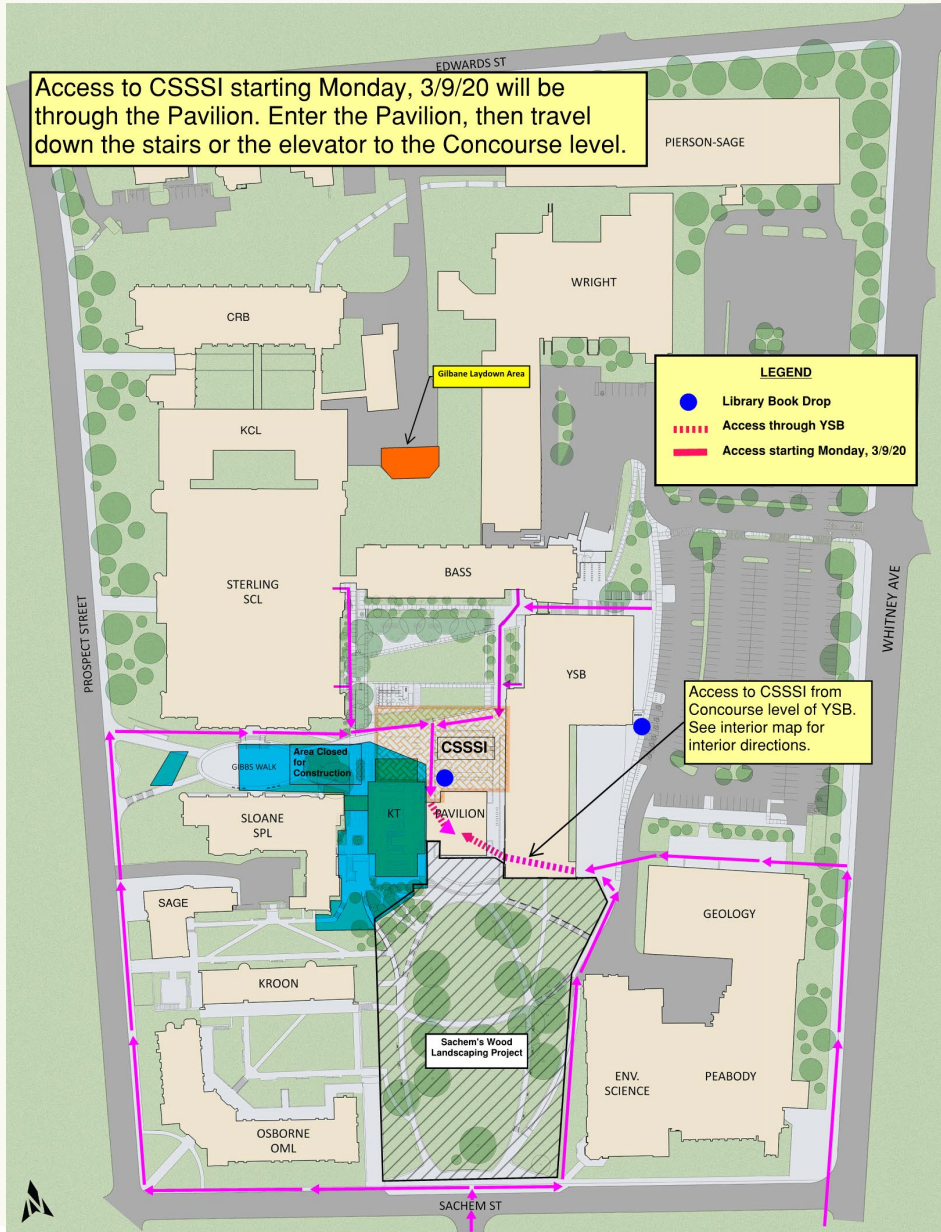

# Project Site Logistics: Phase 1

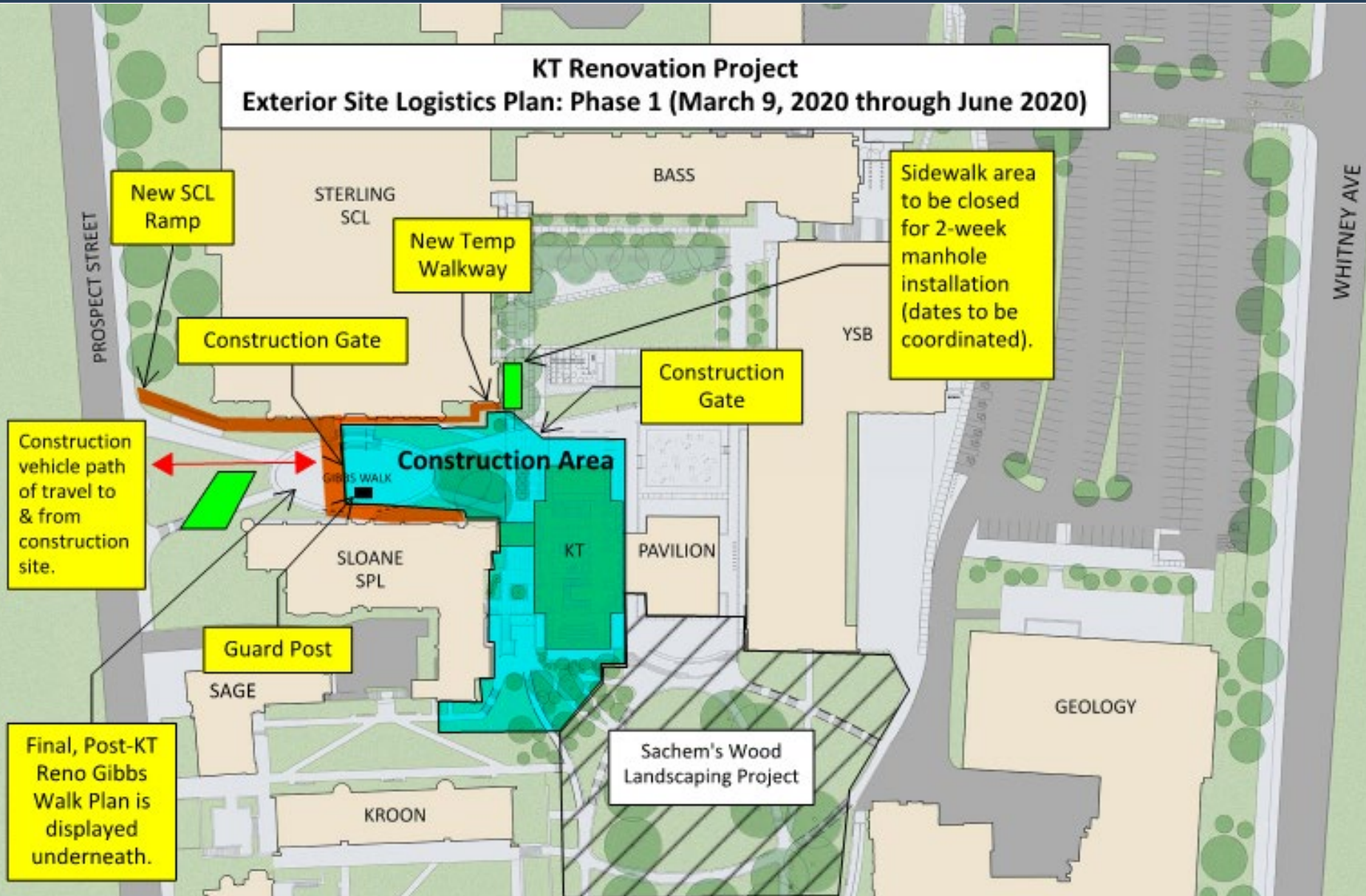

# Project Site Logistics: Phase 2

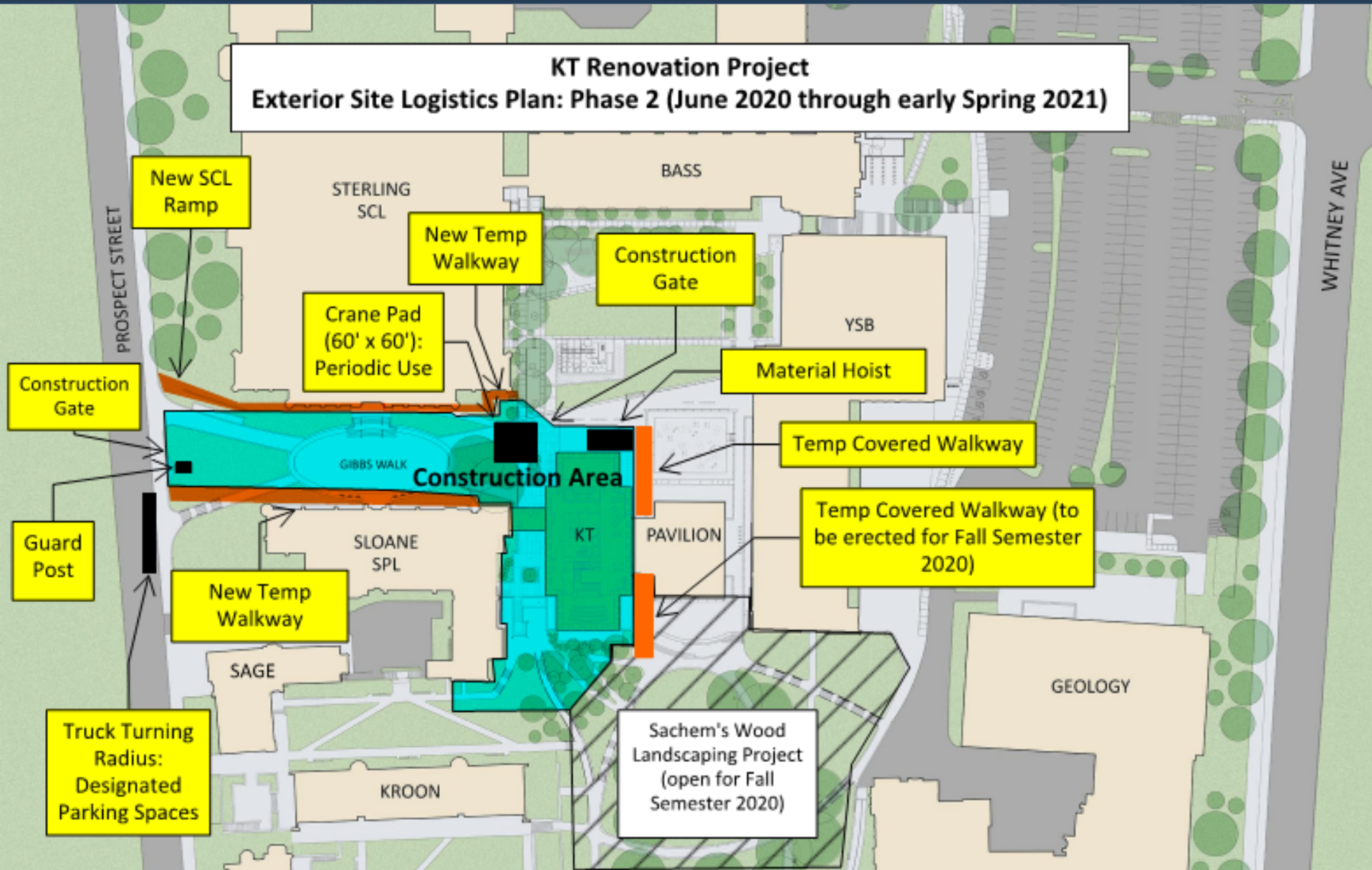

# Project Site Logistics: Phase 3

## KT Renovation Project Exterior Site Logistics Plan: Phase 3 (Spring 2021 through Spring 2022)

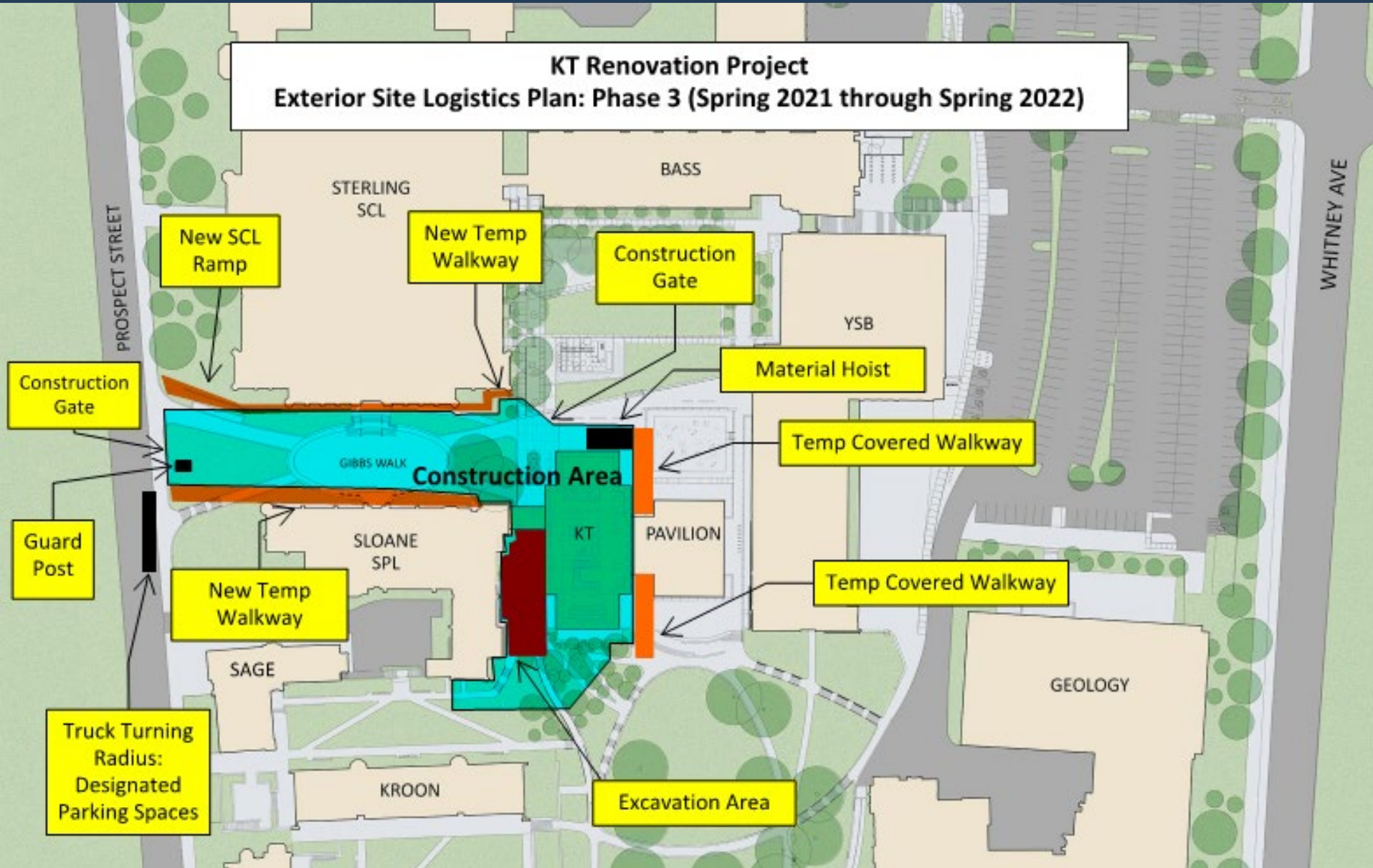

# Project Site Logistics: Phase 4

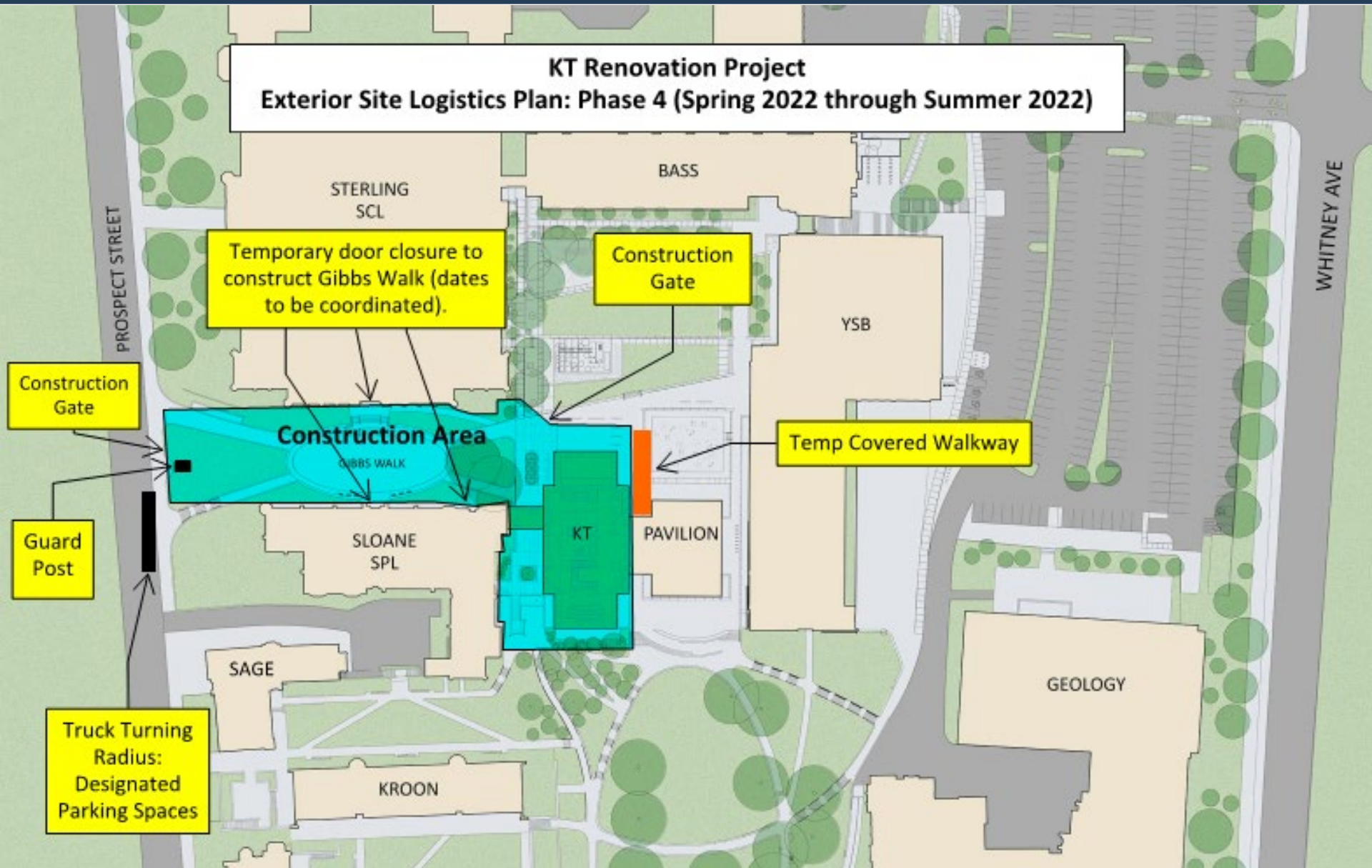

# Project Site Logistics: Interior Door Closures

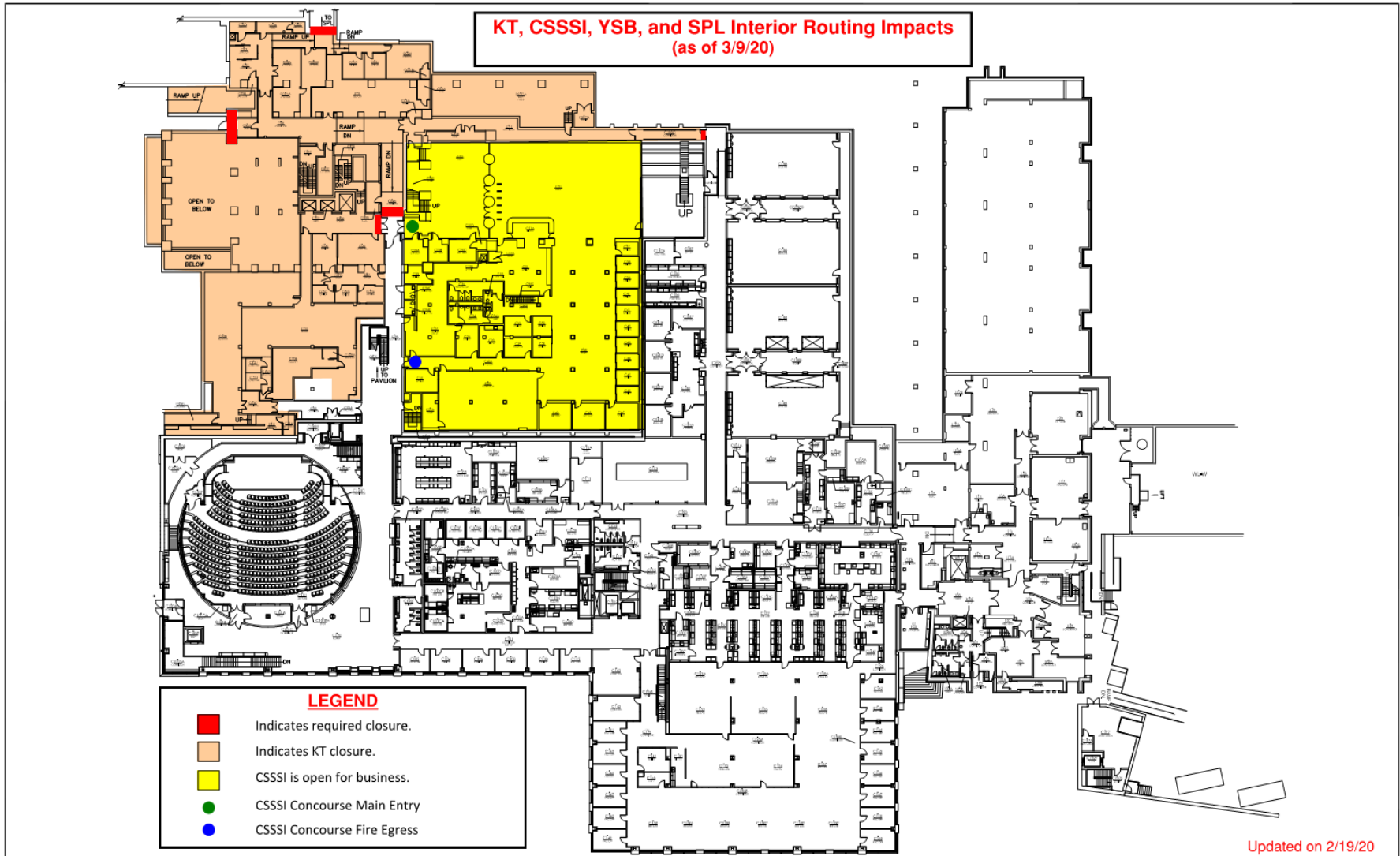

Updated on 2/19/20



Orig. Date: Report Date:  
Rev. Date: Last Export:

**KLINE TOWER - YSB - BASS**  
219 PROSPECT STREET . KT . 1080  
ASSIGNMENT PLAN

CONCOURSE PLAN

KT-YSB-BASS-CONCOURSE LEVEL  
Scale: NTS

# KT Renovation: Overall Project Schedule

- Start construction mobilization on Monday, 3/9/20
  - Substantial completion planned for Summer 2022
- Dates are weather permitting and subject to change
  - Noise and vibration impacts will be minimized as much as possible. Vibration monitoring at milestones, as needed. White noise backup alarms to be utilized.



# KT Renovation: 3 Month Lookahead

- CSSSI book drop relocation (prior to 3/9/20).
- Construction mobilization & erection of perimeter site fencing.
- Set up temporary electric power on south side of KT.
- Commence interior Tower demolition.
- Basement Mechanical Room equipment demolition & removal.
- Erect material hoist
  - Starts in May, when exams finish.
- Closure of CSSSI 24-hour study space.
  - Starts in May, when exams finish.
  - Will remain closed through Summer 2022.

# Get KT Construction Updates



## Science Hill Projects Website Coming Soon

The Yale Science Building website ([yalesciencebuilding.yale.edu](http://yalesciencebuilding.yale.edu)) is becoming a Science Hill Projects website ([sciencehillprojects.yale.edu](http://sciencehillprojects.yale.edu)) and will be live soon.

The website will provide project information, announcements, town hall meeting presentations, and site logistics plans for upcoming construction projects on Science Hill. Visitors will also be able to subscribe (or unsubscribe) to update emails like this one.

Current and upcoming Science Hill projects include:

- Kline Tower Renovation
- Peabody Museum Renovation
- Sachem's Wood Landscaping
- Sloane Physics Lab Exterior Refurbishment

# Questions & Contacts

Visit the Science Hill project website at  
[sciencehillprojects.yale.edu](http://sciencehillprojects.yale.edu)

Shellie Anello

Construction Project Manager

Yale University Office of Facilities

[shellie.anello@yale.edu](mailto:shellie.anello@yale.edu)